

**SAMSUNG**

# UPROAR™



**DUAL-BAND**

TECHNICAL SUPPORT: 888.987.HELP

**TRAINING GUIDE**

NOT FOR RETAIL DISTRIBUTION

Specifications may change without notification.



(Not actual size)

## Standard Package Contains:

- Dual-Band Samsung Uproar
- Standard Lithium Ion Battery
- Dual-Slot Desktop Charger
- Stereo Headset and Remote
- Headset Carry Case
- USB Cable
- MusicMatch Jukebox Plus Software
- Handstrap
- User Guide
- Quick Reference Card
- Accessory Guide

## Telephone Controls

### TALK

Press **SEND** to:

- place and answer calls,
- initiate Three-Way Calling,
- answer a Call Waiting call,
- review the last 5 outgoing, incoming and missed calls from Standby mode.



Press **SEND** twice quickly to redial the last outgoing number.

### CLEAR

Press **CLR** to:

- erase one character at a time,
- return to the previous screen,
- view phonebook entries from Standby mode.



Press and hold **CLR** to:

- erase all entered characters,
- return to Standby mode while viewing menu options.

### END / POWER

Press **END** to:

- end a call,
- return to Standby mode,
- mute the ringer on an incoming call,
- exit MP3 player mode.



Press and hold **END** to turn the phone on and off.

### MENU

Press **MENU** to display the Main Menu and to scan menu options a page at a time.



### OK / MESSAGES

Press **OK** to:

- save menu option settings and Internal Phone Book entries,
- access voicemail, pages, text / browser messages or E-mail from Standby mode,
- mute the ringer on an incoming call.



Press and hold **OK** to access voice messages in one step.

### MP3 KEY

Press the MP3 key to scan menu options, entries in the Internal Phone Book and Call Logs.



In Standby mode, press **MP3** to enter MP3 Player mode.

### POUND

You can skip a space when entering text by pressing **#>**.



### ASTERISK

When entering text, **\*<** lets you select upper or lower case.



### VOLUME

Press the VOLUME buttons to:

- adjust voice volume during conversation,
- adjust ringer volume in Standby mode,
- mute the ringer during an incoming call,
- scroll menus, name/number entries and songs.



### VOICE MEMO

Press **MEMO** to:

- enter the voice memo menu.



Press and hold **MEMO** to:

- record voice memos,
- disable Key Guard.



### **Cigarette Lighter Adapter**

The cigarette lighter adapter offers the convenience of operating or charging your phone's battery from vehicle cigarette lighter sockets.



### **Lithium Ion Batteries**

The standard LiIon battery is ideal for everyday use. The extended LiIon battery provides longer talk and standby times.



### **USB Cable**

The USB cable connects your phone to a personal computer so you can manage your MP3 play list.



### **Dual-Slot Desktop Charger**

The dual-slot desktop charger efficiently charges the battery at your home or office.



### **Travel Charger**

The travel charger is a compact unit that plugs into a wall outlet to charge your phone's battery when you are traveling.



### **Data Cable**

Lets you use your Phone linked to a laptop PC, handheld or palm-sized computing device to send and receive e-mail messages and browse the Internet.



### **Hands-Free Car Kit \***

The hands-free car kit provides safety, freedom and convenience in your vehicle.

\* Professional installation is recommended.



### **Stereo Headset and Remote**

The stereo headset includes earpieces, a microphone, and an MP3 remote control in a convenient, lightweight unit.



*Appearances and specifications subject to change without notice. Accessories shown smaller than actual size.*

### **Charging Time With Accessories**

	<b>Standard Battery</b>	<b>Extended Battery</b>
Dual-Slot Charger (front slot)	3 hrs.	4 hrs.
Travel Charger	3 hrs.	4 hrs.
Hands-Free Car Kit	3 hrs.	4 hrs.
Cigarette Lighter Adapter	3 hrs.	4 hrs.



## Specifications

Operating Frequency	PCS 1900 MHz / Analog 800 MHz	
Graphic LCD	5 Lines (4 text lines, 1 icon line)	
Battery Type	Standard: 800 mAh Lithium Ion Extended: 1300 mAh Lithium Ion	
PCS Antenna	Dual Band Retractable	
	<b>Standard Battery</b>	<b>Extended Battery</b>
Dimensions (H x W x D)	4.1 x 1.8 x 0.9 in 106 x 45 x 23 mm	4.1 x 1.8 x 1.0 in 106 x 45 x 26 mm
Weight	4.2 oz 119 g	4.8 oz 136 g
Talk Time (up to)	3.3 hrs. digital 1.0 hrs. analog	5.0 hrs. digital 1.5 hrs. analog
Standby Time (up to)	140 hrs. digital 16 hrs. analog	210 hrs. digital 24 hrs. analog

## In Use Menu

### The In Use Menu options are available in Conversation Mode

1. (Un)Mute
2. 3-Way Call
3. Calls
4. Messages
5. Phone Book
6. Calendar
0. Version



## Standby Menu

Main Menu	Menu Level 1	Menu Level 2	
1) Music Mode ⇄	1) Play List ⇄	1) Play 2) Information 3) Erase 1) Rewind 2) Play/ Pause 3) Forward 4) Time Display 5) Repeating 6) Equalizer	
	2) Play Mode ⇄		
	3) Call Alert 4) Memory 5) Erase All		
2) Calls ⇄	1) Outgoing 2) Incoming 3) Missed 4) Erase History ⇄	1) Outgoing 2) Incoming 3) Missed 4) All Calls 1) Last Call 2) Lifetime	
	5) Air Time ⇄		
	3) Phone Book ⇄	1) Find Name 2) Add New Entry 3) My Phone# 4) Find Entry 5) Services ⇄	1) Client Care 2) Dir Assist
4) Wireless Web	(Content is determined by service provider)		
5) Messages ⇄	1) Voicemail	1) Listen 2) Reset	
	2) Page/Text 3) Web Alerts 4) Erase		
		1) Page / Text 2) Web Alerts	
6) Network ⇄	1) Set Mode		
7) Calendar ⇄	1) Today 2) Month View 3) Jump to Date 4) To Do List 5) Countdown 6) Alarm Clock 7) World Clock 8) Set Time		
	8) Voice Dial ⇄	1) Record 2) Review 3) Erase All 4) Set Active	↑ SEND only ↓ SEND / Flip
	9) Setup/Tools ⇄	1) Sounds ⇄	1) Ringer Volume 2) Ringer Type 3) Key Beep 4) Tone Length 5) Alert 6) Roam Ringer 1) Backlight 2) Banner 3) Contrast 4) Version
		2) Display ⇄	
		3) Data / Fax In 4) Security ⇄	
		5) Call Answer ⇄	1) Lock Phone 2) Change Lock 3) Special # 4) Erase Phonebook 5) Reset Phone ↑ Any Key SEND Key ↓ Flip Open ↑ Yes No ↓ Car Kit Only ↑ To Start Both To End ↓ None ↑ English ↓ Français
		6) Auto Answer ⇄	
		7) Web Guard ⇄	
8) Language			
9) Calculator 0) SEND Key			



## Display Icons

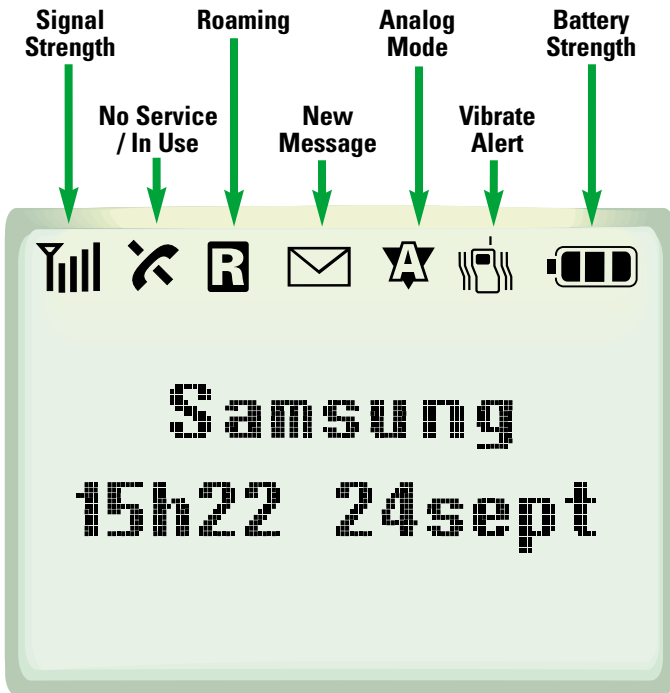

(Not actual size)

## Basic Operations

Turn On / Off	Press and hold <b>END</b> .
Menu Scrolling	Press <b>MENU</b> , and then <b>UP</b> , <b>LEFT</b> or <b>RIGHT</b> .
Make Calls	Enter number, and then press <b>SEND</b> .
Correct Mistakes	Press <b>CLR</b> .
Redial Call	Press <b>SEND</b> twice.
1, 2 or 3-touch Dialing	Enter memory location, and hold the final digit.
End Call	Press <b>END</b> .
Answer Call	Press <b>SEND</b> .
Save Numbers	After entering number, press <b>OK</b> and follow the screen prompts.
Outgoing Numbers	Press <b>MENU</b> , <b>2 ABC</b> , <b>1</b> in sequence to review the last 10 outgoing calls.
Incoming Numbers	Press <b>MENU</b> , <b>2 ABC</b> , <b>2 ABC</b> in sequence to review the last 10 incoming calls.
Missed Calls	Press <b>MENU</b> , <b>2 ABC</b> , <b>3 DEF</b> in sequence to review the last 10 missed calls.
Phone Book	Press <b>CLR</b> in standby mode.

\* Voice-activated dialing is only available on PCS digital networks.

## Special Functions

### 1. Digital Voice Activated Dialing

You can train the phone to recognize up to 20 verbal entries. Record and review entries through the Main Menu. To place a call, press and hold **SEND** or open the flip (according to your menu setting), wait for the prompt, and then say the name into the phone. This feature works wherever digital service is available.

### 2. Finding Phone Book Entries

The phone stores 229 name / number entries alphabetically and by Phone Book entry number. Press **MENU**, **3 DEF**, **1** in sequence to review name entries alphabetically.

### 3. Call Logs

Logs the last 10 outgoing, incoming and missed calls. To access call logs, press **MENU**, **2 ABC**, **1** in sequence for outgoing calls, press **MENU**, **2 ABC**, **2 ABC** in sequence for incoming calls, and press **MENU**, **2 ABC**, **3 DEF** in sequence for missed calls.

### 4. Vibrate Alert

The Vibrate option provides a silent incoming call alert. Press **LEFT** or **RIGHT** in standby mode to scroll through alert options in order to set Vibrate Alert.

### 5. Ring Tone Mute

Mute the ringer during an incoming call by pressing **END** or **DOWN**.

## Samsung Uproar™ Features

- 64MB of MP3 Storage
- Voice Dialing (20 locations)
- Dual Band / Dual Mode
- Web Browser
- Animated User Interface
- Vibrate Alert
- Voice Memo
- Data & Fax Capable
- Organizer
- Text Messaging
- Caller ID
- Ring Tone Mute
- 229 Phone Book Entries
- Active Flip



## Stereo Headset

The Stereo Headset with Remote plugs into the Headset Jack as shown. The MP3 player can also be used with any headset or self-powered multi-media style speakers that has a standard 1/8 inch plug. When doing so, you will lose the included headset's hands-free abilities and remote control.

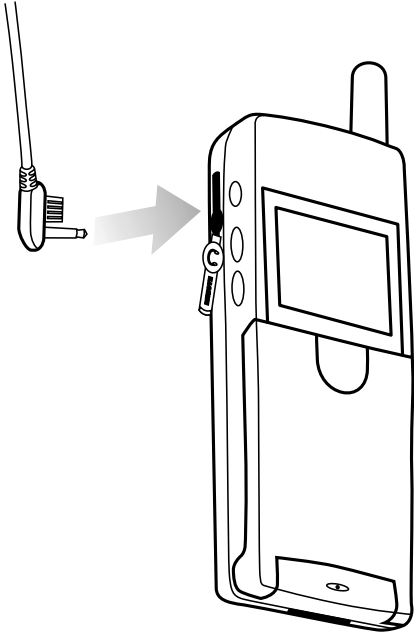

With appropriate cables, the Samsung Uproar can even be used as an audio source for a home stereo, portable stereo or car stereo that offers an auxiliary input. These cables are widely available, and any salesperson knowledgeable in electronics and audio should be able to help select the correct one.

## MP3 Player Controls



### PLAY / PAUSE

Press  to:

- play current song,
- pause a song that is playing,
- return to Music Mode from Standby mode while playing.



### REWIND

Press  to:

- jump to previous song during first two seconds of a song,
- return to the beginning of a song after the first two seconds.

Press and hold  to:

- rewind portions of a song that is playing.



### PLAY / PAUSE

Press  to:

- play current song,
- pause a song that is playing.



### FORWARD

Press  to:

- jump to next song.

Press and hold  to:

- fast forward through portions of a song that is playing.



### TIME

Press  to display the currently playing song's total length and elapsed time.



### REPEAT

Press  to select between the repeat options:

Normal - each song will play in order one time,

**REPEAT** - the current song will replay until stopped,

**REP ALL** - each song will play in order continuously,

**SHUFFLE** - songs in the play list will be chosen randomly.



### EQUALIZER

Pressing the  key lets you to select one of these equalization settings: Normal, **ROCK**, **JAZZ**, **CLASSIC** or **DANCE**.



### RECORD CLIP

By pressing and holding  you can mark a portion of a song to repeat. When you release the button, that passage will replay twice and then regular play will resume.



## Headset Remote Functions

Audio controls on the headset remote will mute the ringer on incoming calls.

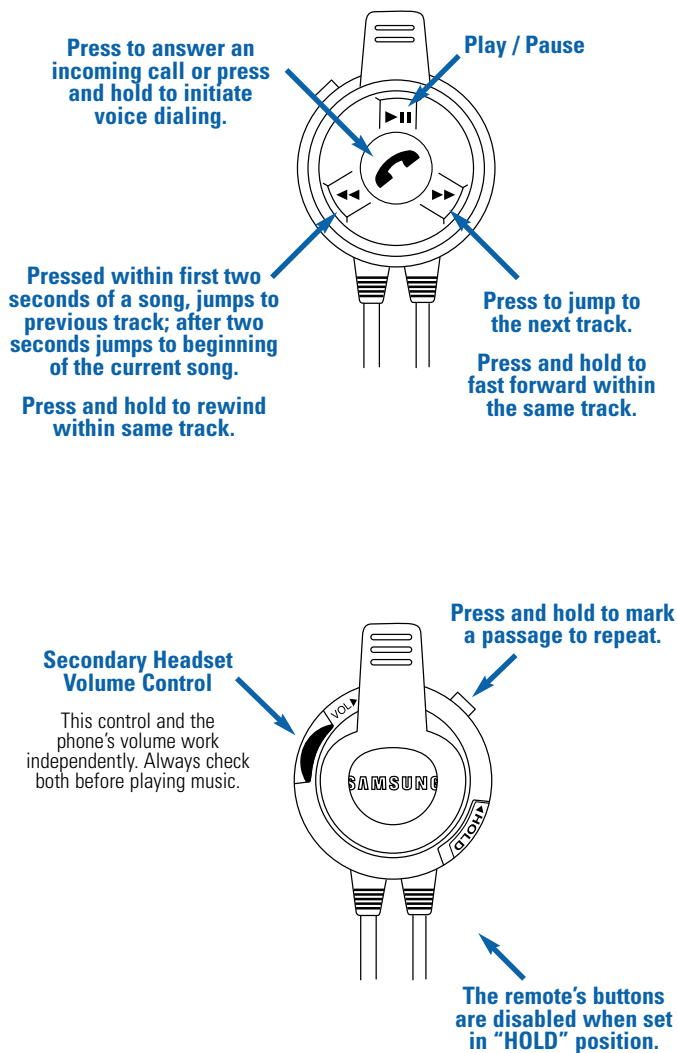

## Downloading MP3 Music Files

Before downloading MP3 music files into your phone, you must download them from the appropriate Internet site to your PC or record ("rip") them yourself from CD's or other sources.

### Downloading MP3 files on your PC to your phone:

1. Insert one end of the download cable supplied with the phone to the connector on the bottom of your phone.
2. Insert the other end of the cable into the USB port on the PC.
3. The phone will display a screen indicating that it is properly connected.
4. Double-click the MusicMatch Jukebox icon on the PC's Desktop.
5. You can also open the MusicMatch Jukebox by selecting programs from the Start menu, then selecting MusicMatch Jukebox.
6. The MusicMatch Jukebox window opens. It may take a couple of seconds for your phone to connect with the PC.

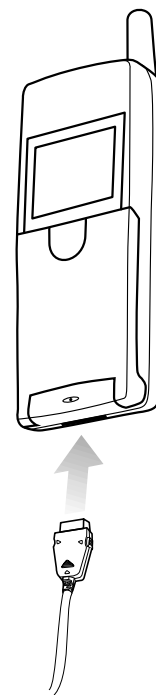



## **Samsung Telecommunications America Background Information**

Samsung Telecommunications America, Inc. (STA), based in Dallas, Texas, was established in 1997 to research, develop and market handheld wireless phones, wireless communications infrastructure systems and network products. Less than one year after its U.S. launch STA reached an industry milestone by shipping more than one million wireless handsets to the U.S. market. In addition, the company has more than a decade of experience in supplying wireless infrastructure and handsets to the world's largest CDMA system in service today.

In the wireless terminals market, the company has signed contracts with several leading providers of wireless communications services, including Sprint PCS, Bell Mobility and AT&T Wireless Services. The company supplies Code Division Multiple Access (CDMA) handsets, including single-band CDMA, dual-band/dual-mode CDMA, tri-mode CDMA and dual-mode cellular handsets.

Samsung Telecommunications America, a Dallas-based subsidiary of Samsung Electronics Company, researches, develops, and markets telecommunications and data communications systems and products throughout North America. STA has four main business groups: Wireless Terminals, Wireless Systems, Broadband Network Terminals and Business Communications. Samsung Electronics Company, Ltd., a \$22.8 billion flagship company of the Samsung Group, is a worldwide producer of telecommunications systems, consumer appliances, A/V equipment, computers, printers, and semiconductors.

Printed in Canada

©2001 SAMSUNG TELECOMMUNICATIONS AMERICA, Inc.



SAMSUNG TELECOMMUNICATIONS AMERICA  
1130 E. Arapaho Road  
Richardson, TX 75081  
1-800-SAMSUNG  
[www.samsung.ca](http://www.samsung.ca)

1922000028  
02/01.4,000